

**ALL ORION LAUNCHERS ARE DESIGNED TO BE USED  
EXCLUSIVELY WITH ORION SIGNALS ONLY.  
USE OF ANY OTHER SIGNAL OR SHELL IS DANGEROUS  
AND VOIDS ALL CLAIMS AND WARRANTIES.**

The Orion 12-Gauge launcher is designed to fire Orion 12-Gauge, red and white, aerial signals and Orion 12-Gauge High Performance, single and twin, red aerial signals. The Orion 25MM launcher is designed to fire Orion 25 MM, red and white, aerial signals and Orion 25MM, red and white, Parachute signals. The 25MM Launcher, with use of an Orion 12-Gauge converter, can also fire Orion 12-Gauge, red and white, aerial signals and Orion 12-Gauge High Performance, single and twin, red aerial signals.

**LIFETIME LAUNCHER WARRANTY & SERVICE PROGRAM**

Orion 12 gauge and 25MM launchers carry a lifetime warranty if used exclusively with applicable Orion aerial signals. In addition, Orion launcher service program allows customers to send their launchers to Orion in the off-season to verify functionality. The launchers are run through a battery of test to make certain performance has not degraded over time due to extreme environmental, use or storage conditions. If you have a launcher that has failed or if you simply want your launcher serviced, please send your launcher (verify it is empty with no signals in the chamber) to the following address with a note explaining the launcher deficiency or service request and your return address: Orion Launcher Service Program  
Orion Safety Products P.O. Box 1047, Easton, MD 21601



**Step 1**

For most effective use, fire only after sighting potential rescue vessel.

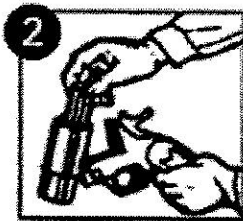

**Step 2**

**12-Gauge Launcher**

Break launcher barrel open, insert ORION 12-Gauge HP aerial flare and close launcher.\*

**25MM Launcher**

Depress plastic button on side of launcher to open barrel. Insert 25MM signal or converter and 12-gauge signal. Close launcher. \*



**Step 3**

Hold launcher above eye level, point straight up, cock hammer and squeeze trigger\*\*. Repeat with second signal.

*\*If the barrel does not fully close, DO NOT FORCE IT, check that the signal is pushed all the way into the barrel. If the barrel will still not close carefully remove the signal and use another signal, repeat Step 2.*

*\*\* If a signal does not fire after it has been fully placed in the barrel and the launcher is fully closed, the hammer is pulled back, and the trigger is squeezed, DO NOT IMMEDIATELY OPEN THE LAUNCHER. While rare, a hang-fire (delayed launches after squeezing the trigger) can be very dangerous. Point the launcher overboard towards the water, wait at least 5 seconds, then open launcher and replace signal, repeat Step 2.*

Orion launchers are designed for Marine Emergency use ONLY. It is illegal to fire signals in a non-distress situation. Caution: Aerial signals are extremely flammable. Store in a dry accessible area, out of reach of children.